

Necessary tool

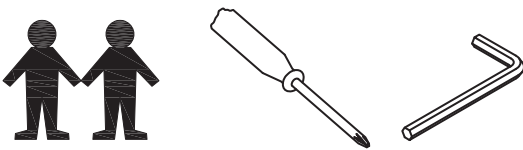

Component list

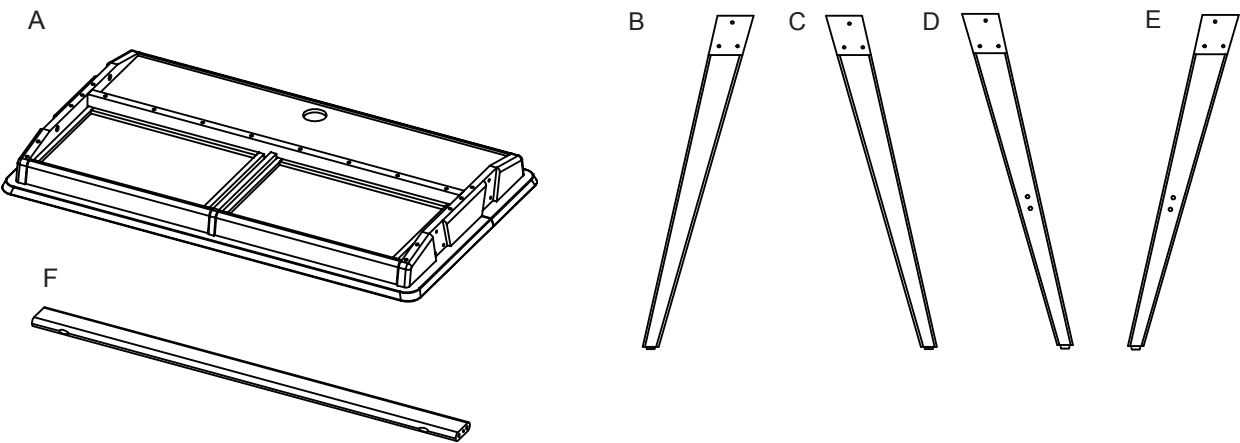

Fitting list

① X12

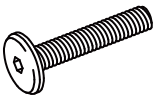

② x 12



③ x 12



④ x 1

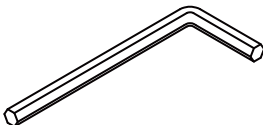

⑤ x 2



STEP BY STEP ASSEMBLY INSTRUCTION

STEP 1

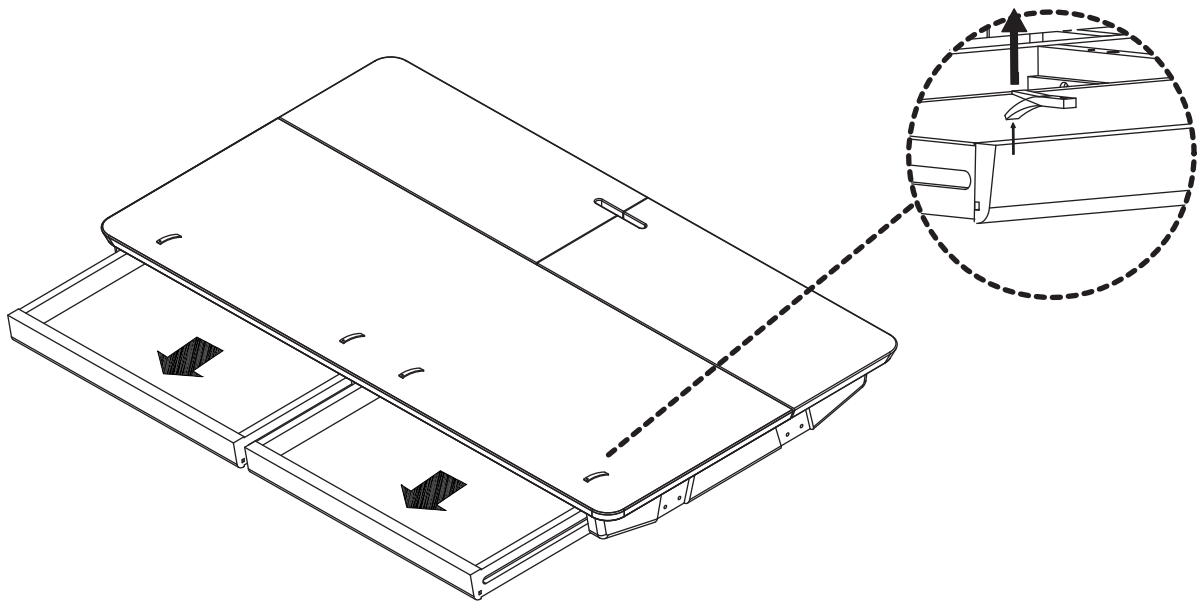

STEP 2

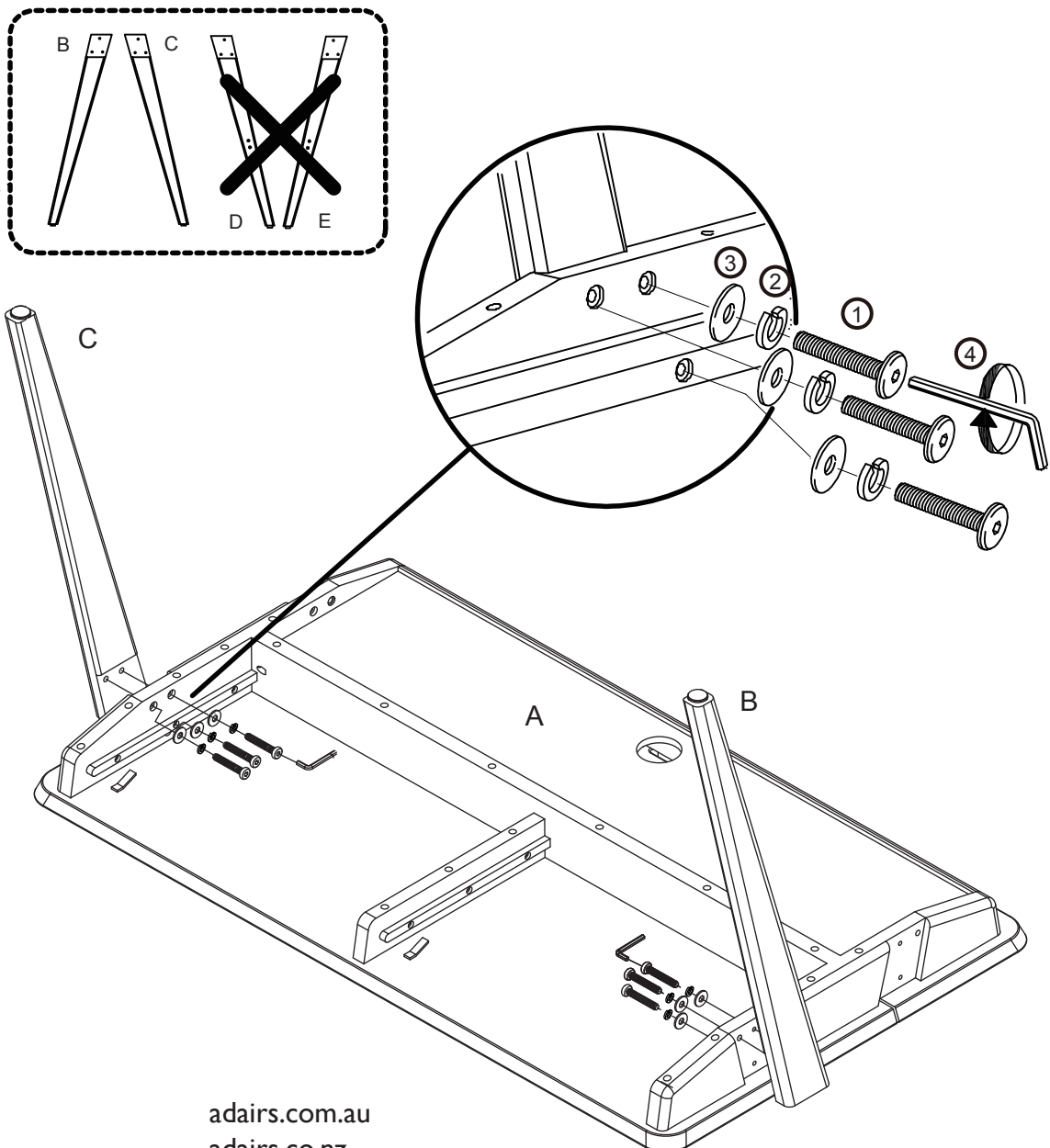

STEP 3

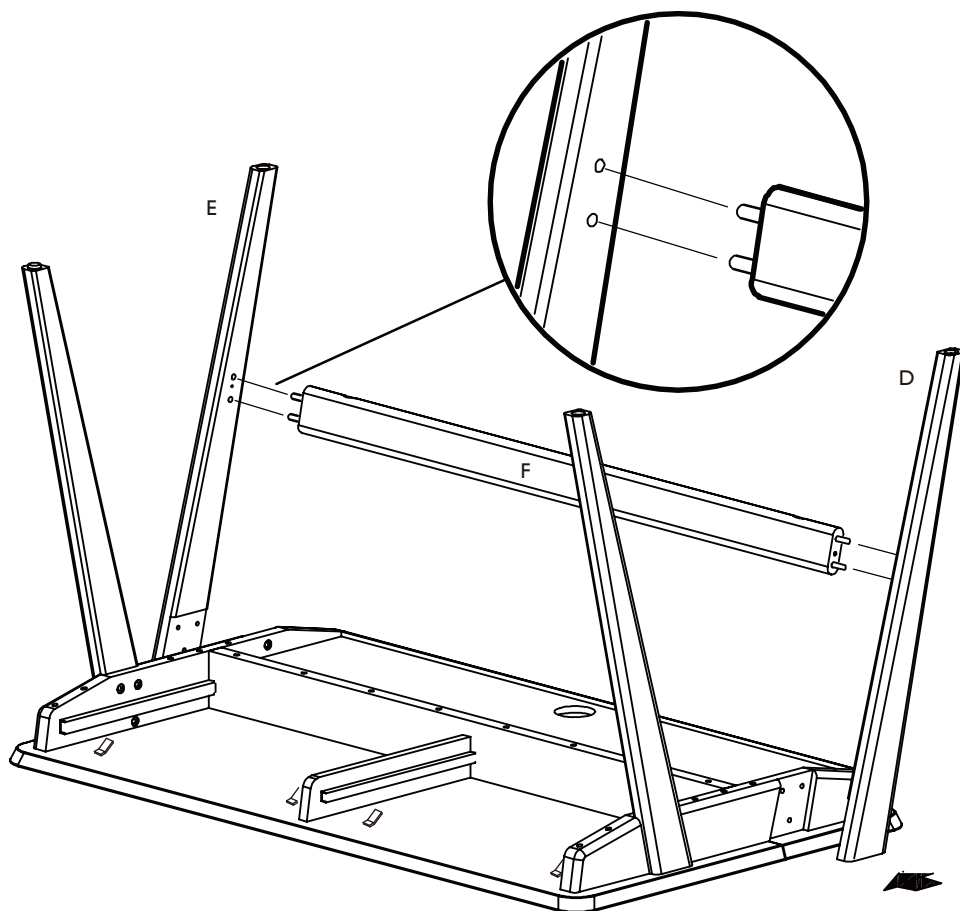
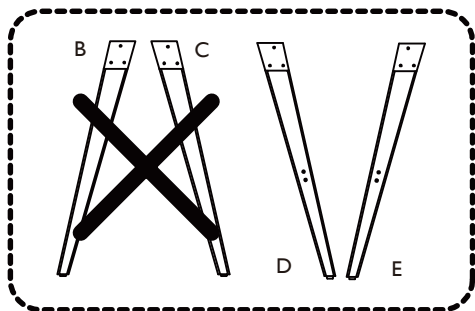

STEP 4

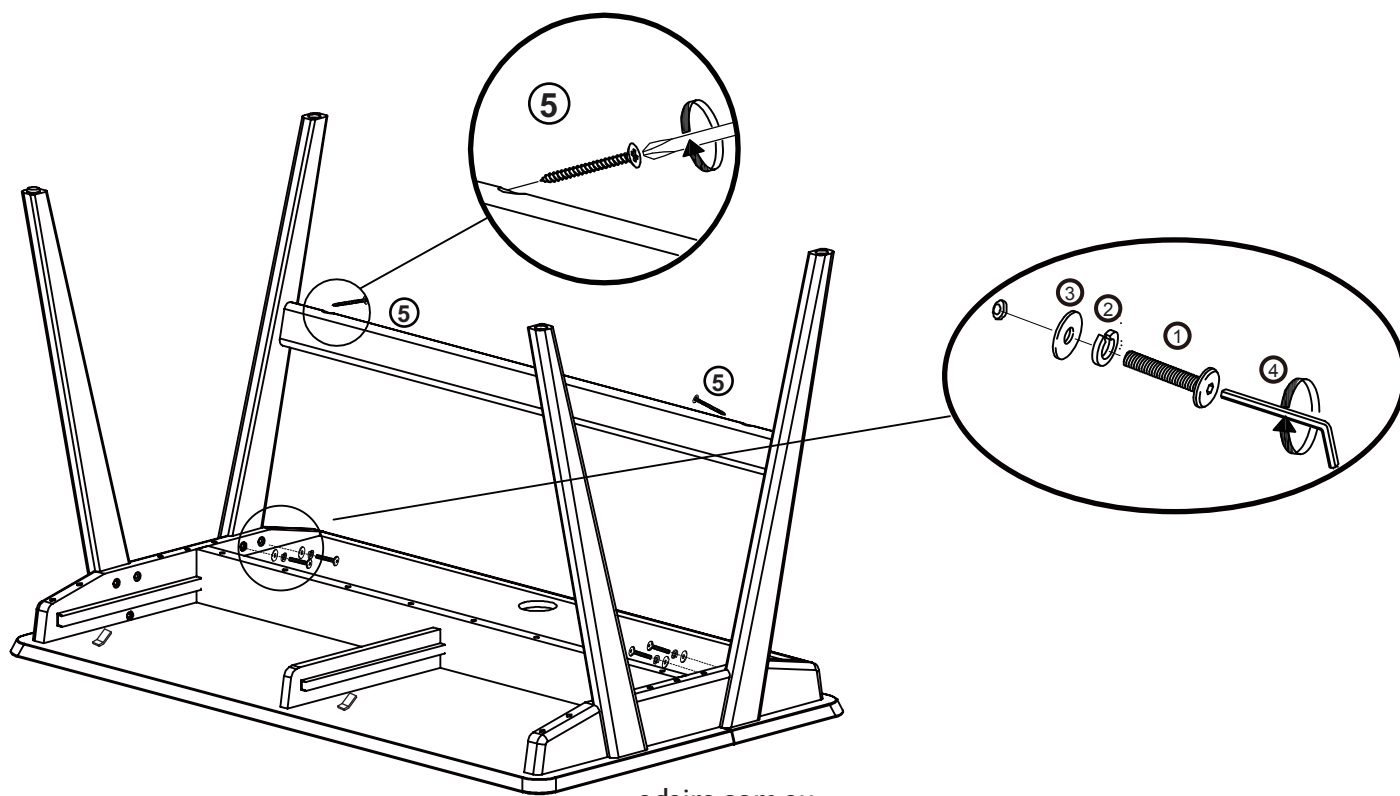

STEP 5

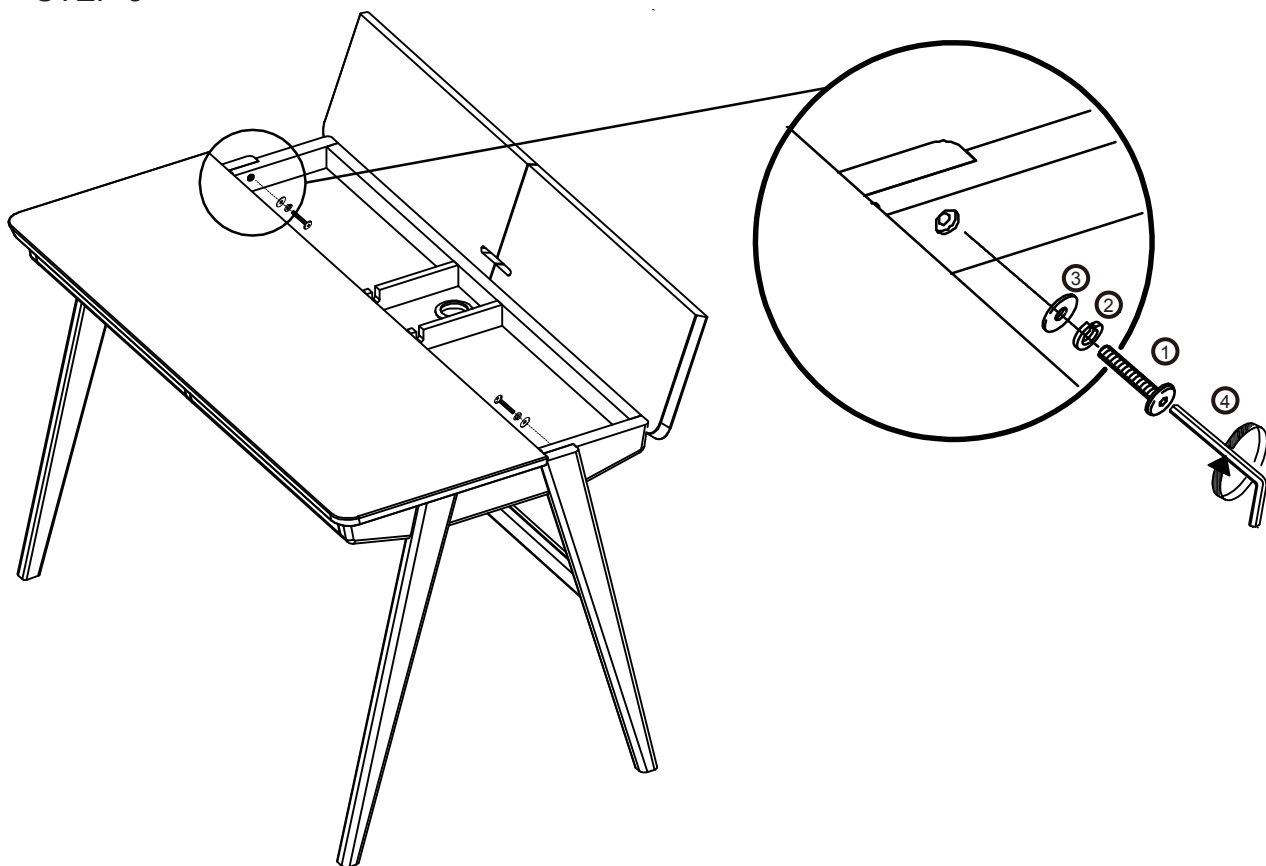

STEP 6

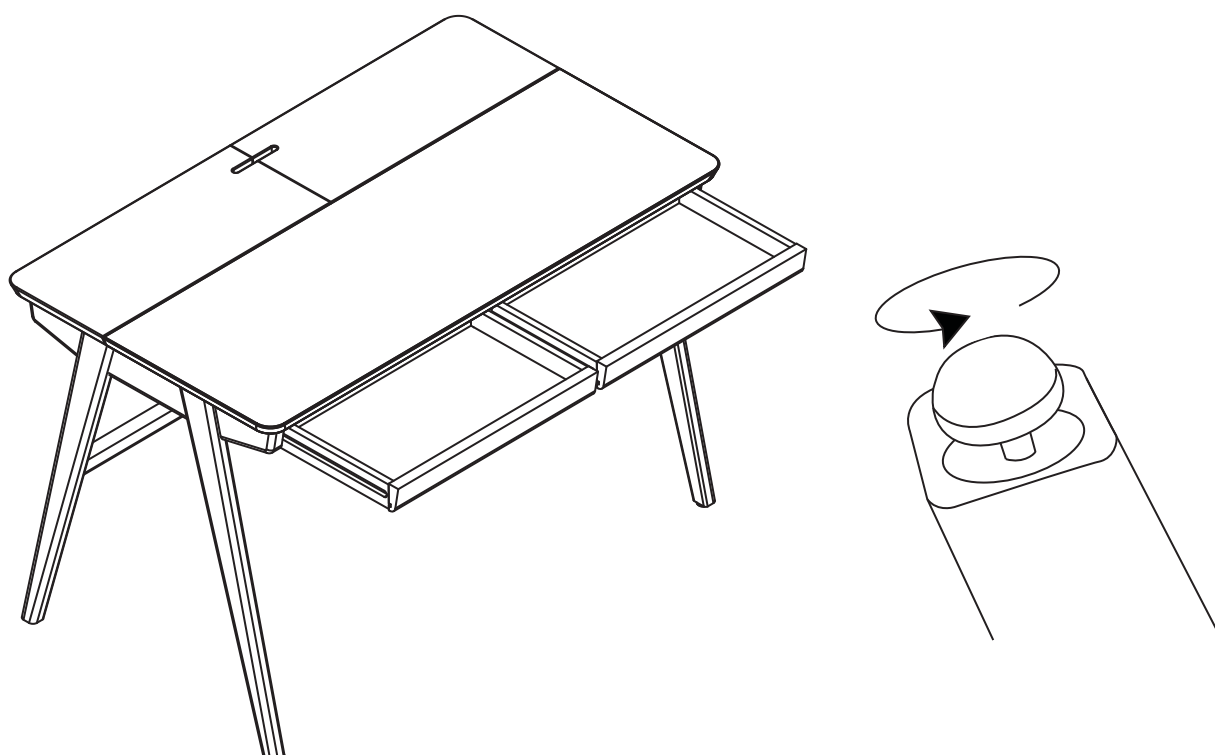



WARNING:

It is **STRONGLY RECOMMENDED** that you **ANCHOR** this product.

Toppling furniture can cause serious injuries and death.

This product has not been fitted with an anchor strap/bracket* (*select as *appropriate*). To prevent your furniture from tipping forward it is strongly recommended that you **securely attach this product** to a wall or other solid surface, using the anchor straps/brackets provided and appropriate fixings.

IMPORTANT:

Regularly check that anchors are securely maintained.

Use safety **drawer locks** to prevent children climbing.

Stability of tall items may be affected by thick pile carpet or uneven floors.

Do not place unanchored televisions on furniture

CAUTION:

For your safety when attaching the anchor fixings, please note the following:

- Check for any electrical wires or plumbing inside the wall before drilling any holes (if you are unsure please seek professional advice from a qualified tradesperson)
- Walls are constructed from different materials, for example, masonry (solid brick) or plasterboard lined cavity walls (hollow). It is important that you use the appropriate wall fixings for your wall type.
- Your local hardware store will have the necessary drills and fixings and can offer advice if needed. If in doubt, engage the services of a qualified tradesperson to install and anchor the product.

ANCHOR points fitting

⑥ x 1



⑦ x 2



⑧ x 2

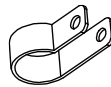

⑨ x 1



Required Tool

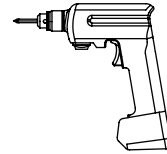
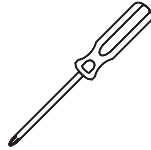

Step 1: fix the fittings on the back of product.

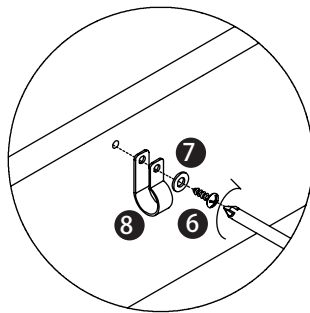

Step 2: Example of fixing the fittings on the wall.

*** Not supplied, it depends on the material and circumstances of the wall**

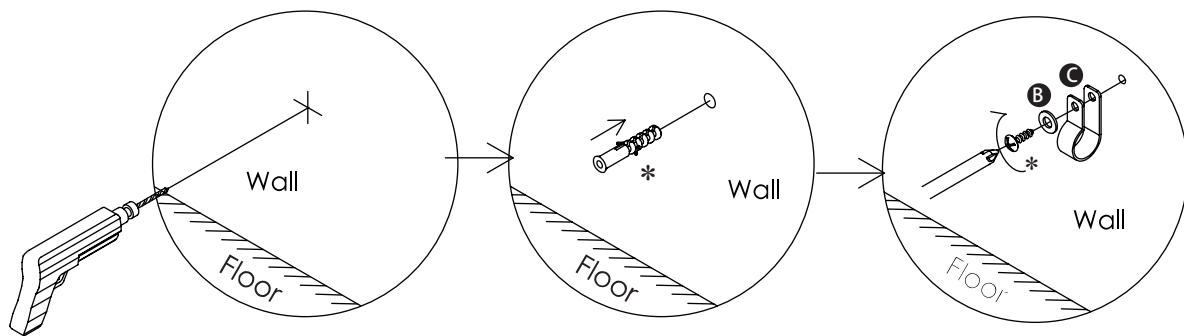

Step 3: Use strap connect product with the wall

